



39 Souhegan Street - P.O. Box 269, Wilton, New Hampshire 03086  
 TEL (603) 654-2002 FAX (603) 654-2533  
 email: sales@shp-seals.com - website: www.shp-seals.com

ISO 9001:2015 Certified

**HERMETIC  
MICRO D CONNECTORS**



Our patented design is based on the same principles as our popular "aluminum compatible" feedthrus which have provided unparalleled reliability in rugged thermal environments for two decades. They are available in a number of configurations, materials and finishes for compatibility with various housing materials, mating connectors and attachment methods. US Patent# 6,821,145.

SPECIFICATION	SOLDERABLE & LASER WELDABLE
Temperature	-65°C - +200°C
DWV (Pin to Ground)	350 Vdc @ S.L.
Contact Rating	3 Amps
Leak Rate	Less than 1 X 10 <sup>-8</sup> std. cc/sec. at 1 ATM (He)
Mechanical	Interface per MIL-PRF-83513

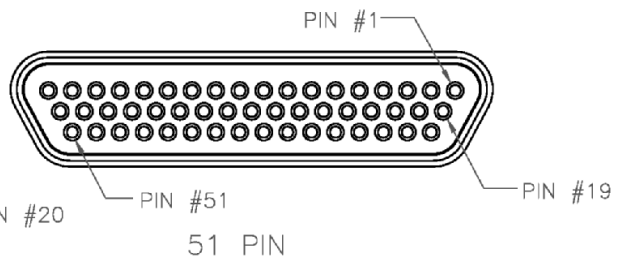
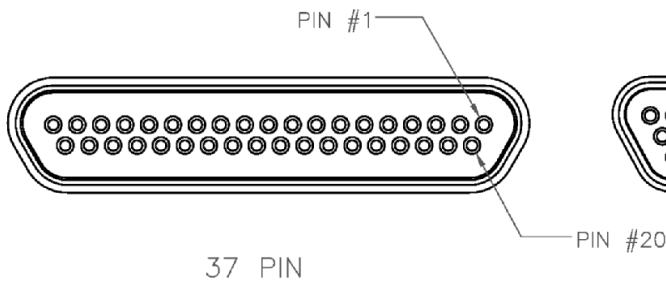
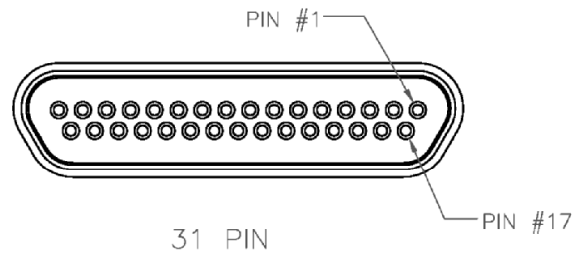
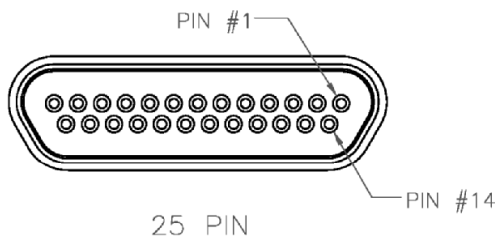
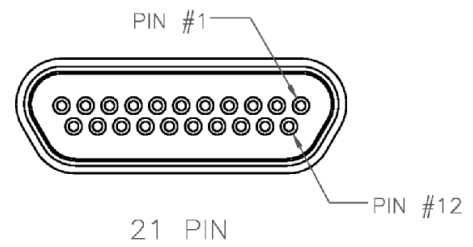
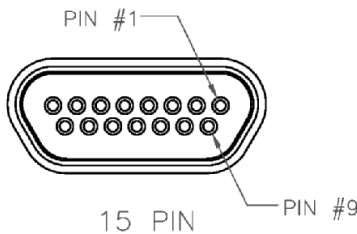
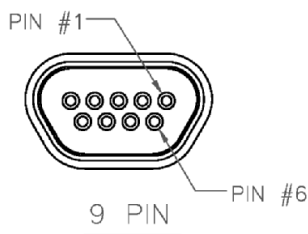

**Note: Socket side view of connector**



39 Souhegan Street - P.O. Box 269, Wilton, New Hampshire 03086  
 TEL (603) 654-2002 FAX (603) 654-2533  
 email: sales@shp-seals.com - website: www.shp-seals.com

ISO 9001:2015 Certified

**HERMETIC  
MICRO D CONNECTORS**

HOUSING APPLICATION	ATTACHMENT METHOD	PART NUMBER	NO. OF CONTACTS	CONNECTOR BODY MATERIAL	SHELL FINISH <sup>(2)</sup>
ALUMINUM	Laser Weld	HMMDA-1WDx-xP-xxx-xx	9, 15, 21, 25, 31, 37, 51	4047	CHROMATE
	Solder <sup>(3)</sup>	HMMDA-1SDx-xP-xxx-xx		6061	NICKEL or GOLD
ASTM-F15 (KOVAR)	Laser Weld	HMMDK-1WDx-xP-xxx-xx		ASTM-F15 (KOVAR)	NICKEL
	Solder <sup>(3)</sup>	HMMDK-1SDx-xP-xxx-xx			GOLD
STAINLESS STEEL	Laser Weld	HMMDS-1WDx-xP-xxx-xx		304L	NICKEL or NONE
	Solder <sup>(3)</sup>	HMMDS-1SDx-xP-xxx-xx		303	NICKEL or GOLD

**TERMINATION/CONFIGURATION CODES**

TERM. CODE	Pin Length In. <sup>(1)</sup>	Uniform 2 Rows			Staggered 2 Rows		Staggered 3 Rows		
		.109	.159	.209	.109, .159	.159, .209	.109, .159, .159	.109, .159, .209	.159, .209, .209
Straight Cut		110	120	130	SSC	113	115	SSC	119
	Machined Flat	NA			SMF	213	NA	SMF	NA

Example Part No: HMMDA-1SD1-21P-130-G1 = 21 Pin connector

PART NUMBER

**Standard Pin Terminations**

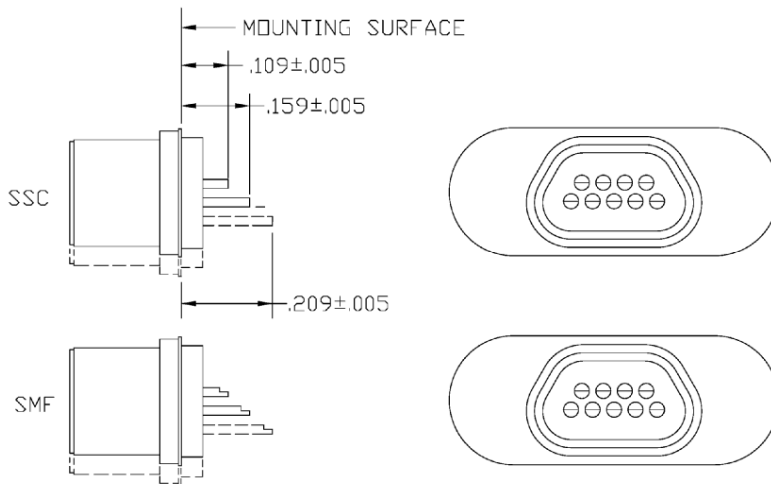

Optional pin flats .015 in. min. square (see SMF above)  
 See bulletin 501 for sleeves, available for axial wire/pin splice

HMMDA-1SDx-xP-xxx-xx

**HOUSING APPLICATION**

A - Aluminum  
 K - Kovar  
 S - Stainless

**ATTACHMENT METHOD**

1WD - Standard Laser Weldable  
 1SD - Standard Solderable

**HARDWARE INSTALLATION<sup>(4)</sup>**

0 - Gasket Separate<sup>(5)</sup>  
 1 - Gasket Installed

**NO. OF CONTACTS**

9, 15, 21, 25, 31, 37 or 51 pins

**TERMINATION/CONFIGURATION CODE**

See table above

**PLATING CODE (SHELL FINISH)<sup>(2)</sup>**

C1 - Chromate N1 - Nickel G1 - Gold 00 - None

- Notes:
- (1) These lengths are standard, other lengths and combinations are available.
  - (2) Contact SHP for other plating options.
  - (3) See bulletin 210 for solder preforms.
  - (4) Connectors can ship with or without gasket installed. Please specify.
  - (5) Contact SHP for gasket installation tool.

All dimensions are inches.



39 Souhegan Street - P.O. Box 269, Wilton, New Hampshire 03086  
 TEL (603) 654-2002 FAX (603) 654-2533  
 email: sales@shp-seals.com - website: www.shp-seals.com

ISO 9001:2015 Certified

**HERMETIC  
 MICRO D CONNECTORS**

**PATENTED**  
**US Patent# 6,821,145**

**WELDABLE**

PINS	Rows	X ±.002	L ±.002	W1 ±.002
9	2	.565	.775	.307
15	2	.715	.925	
21	2	.865	1.075	
25	2	.965	1.175	
31	2	1.115	1.325	
37	2	1.265	1.475	
51	3	1.215	1.425	.350

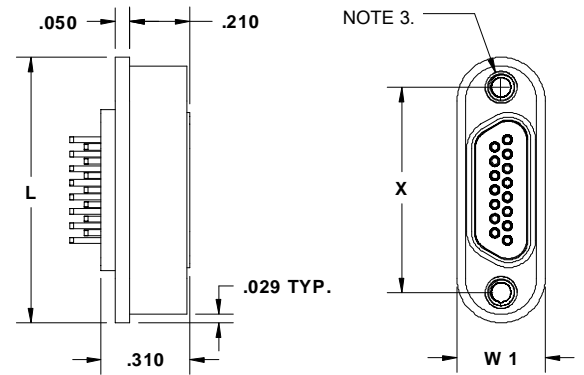
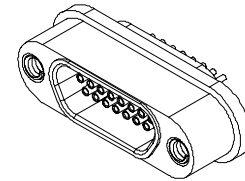

**SOLDERABLE**

PINS	Rows	X ±.002	L ±.002	W1 ±.002
9	2	.565	.767	.299
15	2	.715	.917	
21	2	.865	1.067	
25	2	.965	1.167	
31	2	1.115	1.317	
37	2	1.265	1.467	
51	3	1.215	1.417	.342

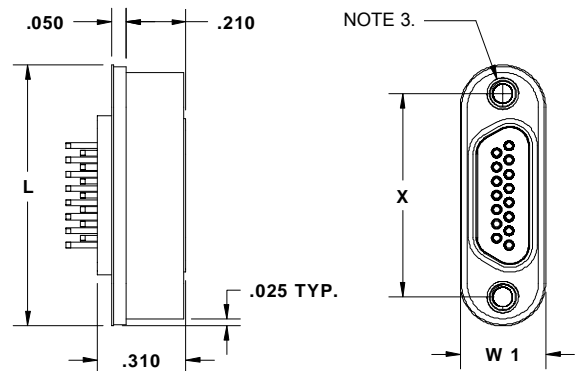
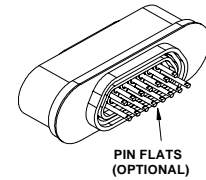

- NOTES:** (1) Dimension 'X' per MIL-PRF-83513 (metal Shell Connectors).  
 (2) See Page 2 of Bulletin for Part No. construction.  
 (3) Stainless steel thread inserts on aluminum housings; others threaded.  
 (4) 51-pin connector has 3 rows of pins per MIL-PRF-83513.

All dimensions are inches.



39 Souhegan Street - P.O. Box 269, Wilton, New Hampshire 03086  
 TEL (603) 654-2002 FAX (603) 654-2533  
 email: sales@shp-seals.com - website: www.shp-seals.com

ISO 9001:2015 Certified

**HERMETIC  
 MICRO D CONNECTORS**

**SOLDER APPLICATION**

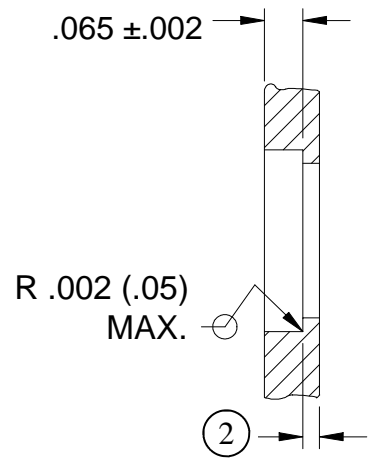
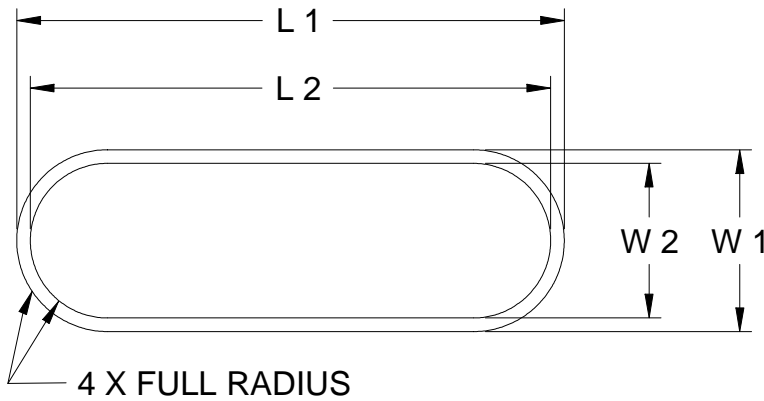

PINS	L1 ±.001	L2 ±.002	W1 ±.001	W2 ±.002
9	.771	.738	.303	.270
15	.921	.888		
21	1.071	1.038		
25	1.171	1.138		
31	1.321	1.288		
37	1.471	1.438		
51	1.421	1.388	.346	.313

- (1) Tolerances are  $\pm .001$  unless otherwise specified.
- (2) This dimension should provide minimal support to connector and sufficient pin protrusion into housing cavity. For thick walls, longer pin lengths are available.

All dimensions are inches.



39 Souhegan Street - P.O. Box 269, Wilton, New Hampshire 03086  
 TEL (603) 654-2002 FAX (603) 654-2533  
 email: sales@shp-seals.com - website: www.shp-seals.com

ISO 9001:2015 Certified

**HERMETIC  
MICRO D CONNECTORS**

**LASER WELD APPLICATION**

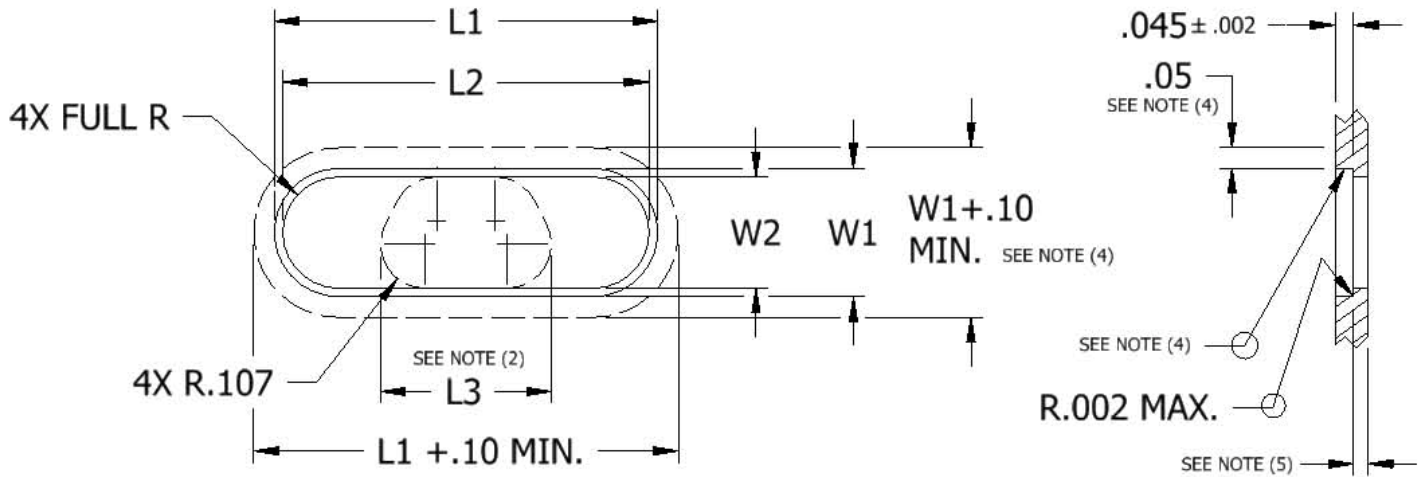

PINS	L1 ±.001	L2 ±.002 <sup>③</sup>	L3 ±.002 <sup>②</sup>	W1 ±.001	W2 ±.002 <sup>③</sup>
9	.779	.738	.414	.311	.270
15	.929	.888	.554		
21	1.079	1.038	.714		
25	1.179	1.138	.814		
31	1.329	1.288	.964		
37	1.479	1.438	1.114		
51	1.429	1.388	1.164	.354	.313

- (1) Tolerance is ±.001 unless otherwise specified.
- (2) Optional dimensions for keying.
- (3) L2 & W2 for maximum opening.
- (4) Free of plating, all around.
- (5) This dimension should provide support to connector and sufficient pin protrusion into housing. For thick walls, longer pin lengths are available.

All dimensions are inches.